

**Powers Court  
Cambridge Park  
East Twickenham  
TW1 2JJ**

£1,300,000

**ChaseBuchanan**





## Powers Court TW1

Approximate Gross Internal Floor Area = 133.5 sq m / 1437 sq ft

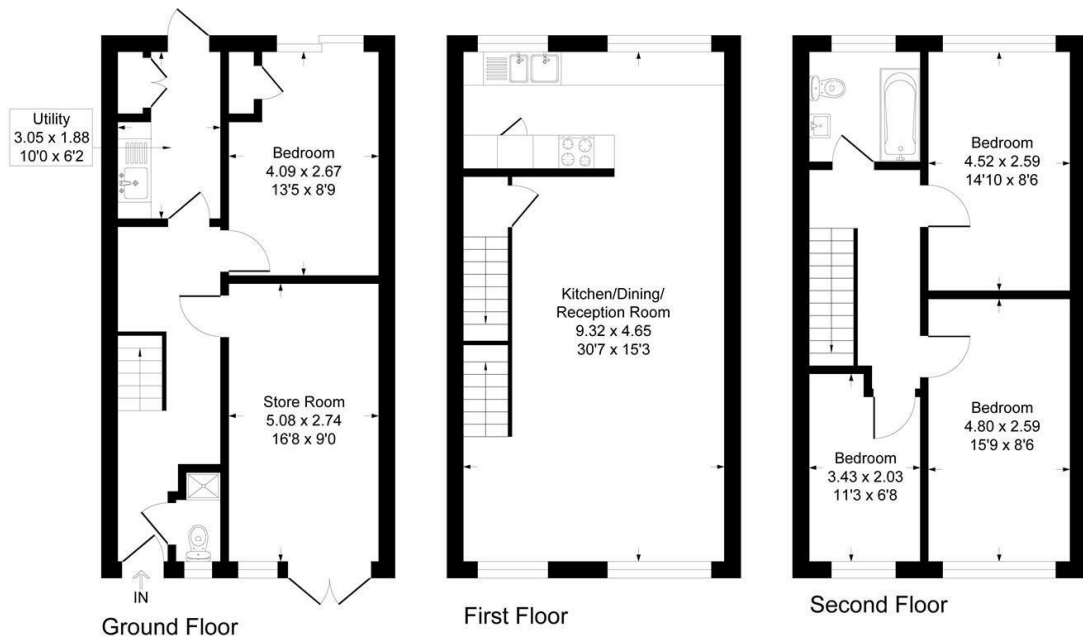

Illustration for identification purposes only, measurements are approximate, not to scale.

- Viewings accompanied by Chase Buchanan
- Four bedrooms
- Garage and OSP
- Adaptable accommodation
- Large corner plot
- Townhouse
- Scope for extension and development (STP)
- Large South facing rear and side gardens

Set on a generous and envious corner plot situated within Cambridge Park and moments from Richmond bridge this four bedroom, two bathroom contemporary town house has been subject to some recent renovations by the current owners, yet still boasting substantial opportunity to further extend and develop (STP) The property boasts a bright and modern interior with spacious accommodation over three floors perfectly designed for modern family living.

The ground floor currently comprises an integral garage, down stairs WC, a fourth bedroom or further reception room leading to the garden and a large utility area.

The first floor has been opened up to form a large double aspect reception room open to a kitchen area. The top floor boasts three bedrooms and a family bathroom.

Externally the residence is extremely generous with a large South facing walled rear gardens to both side and rear of the property, to the front is off street parking.

Powers Court is a leafy residential development situated within Cambridge Park, close to Richmond Town Centre , The River Thames and Marble Hill Park.

An appointment to view is highly recommended via the vendors sole agents Chase Buchanan at the earliest opportunity.

For more information or to book a viewing, please contact:

020 8744 2434

**ChaseBuchanan**

124 St Margarets Road, St Margarets, TW1 2AA

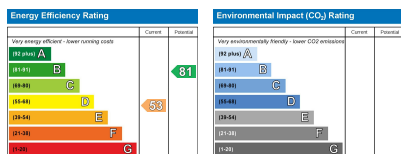

Care has been taken in the preparation of these particulars, however, their accuracy is not guaranteed and they do not form part of any contract. Measurements stated must be considered maximum.